



## DEFINITY™ G25

### BENEFITS

- Dimmable to 5% of light on most dimmers.
- 8 Watts – up to 84% more efficient than comparable 50 Watt Incandescent lamp.
- Maintenance free operation, lasts up to 20 times longer than incandescent lighting.
- RoHS compliant – contains no mercury or lead.

### FEATURES

Equivalent Source	
Standard	Up to 50W Incandescent
L70 lumen depreciation design criteria =	50,000 hours
ENERGY STAR life=	35,000 hours <sup>2</sup>
Housing	Aluminum
Socket	E26/GU24
Operating Temperature	-20°C to +40°C
E26 MOL	4.68 in, 118.88mm
GU24 MOL <sup>4</sup>	4.97 in, 126.23mm
Voltage	120 VAC
Weight	0.33lbs., 150g
Power Factor	≥.90
Warranty	5 year limited

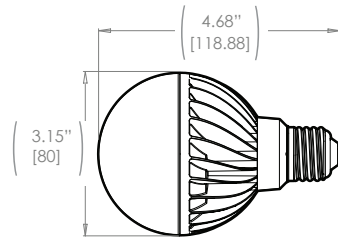

### ORDERING INFORMATION \ \ DFN 25 WW 120

Family	Product	Color (CCT)	Voltage	Base
DFN Definity	25 G25	W27 Warm White 2700K	120 120 Volt	Leave blank for E26 base
		WW Warm White 3000K		GU24 GU24
		NW Neutral White 4000K		
		CW Cool White 5000K		

#### CERTIFICATIONS NORTH AMERICA



#### ENVIRONMENT





**Manufacturer:** Superior Lighting  
**Model Number Tested:** **ECS 25 40WE W27 120**  
**Other Model Numbers:** DFN 25 40WE W27 120; DFN 25 40WE WW 120; DFN 25 40WE NW 120; DFN 25 40WE CW 120

**Manufacturer's Description**

Type of device:	<u>LED Ecosmart soft white G25 E26 base</u>	Control Type:	<u>Forward Phase</u>
Operating voltage:	<u>120V</u>	Dimming Range:	<u>Not Specified</u>
Input Power:	<u>7.0 W</u>	Output Power:	<u>Not Specified</u>
Input Current:	<u>0.60 A</u>	Lumen Output:	<u>400</u>
Input Frequency:	<u>60Hz</u>		

**Lutron Test Results**

Test Voltage: 120 V

**Lutron Recommended Compatible Products**

*Lutron products not in this list can be considered to be not recommended, based on our testing.*

Product	Model Number	Fixtures per Dimmer		Measured Dimming Range <sup>(1)</sup>		Perceived Low End <sup>(2)</sup>	Comments
		Minimum	Maximum	Low End	High End		
<b>Wallbox Dimmers</b>							
Diva/ Skylark/ Skylark Contour/ Ariadni/ Toggler	C-L wall-mount dimmers (T1)*	2	21	20%	96%	45%	Low end trim required.
Maestro	MACL-153M ( )*	1	21	15%	92%	39%	Low end trim required.
Maestro Wireless	MRF2-6ND	1	20	20%	90%	45%	Low end trim required.
Maestro Sensor	MSCL-OP153M (T2)*/ MSCL-VP153M (T2)*	2	21	13%	95%	37%	Low end trim required.
<b>Commercial Systems</b>							
Panel Module	HW/LP-RPM-4A-120	1	40	20%	98%	45%	Low end trim required. Set load type to FP. Rating is per channel; total per module is 64.
<b>Residential Systems</b>							
RadioRA 2	RRD-10ND	1	21	20%	90%	45%	Low end trim required.
HomeWorks QS	HQRD-6ND	1	20	20%	90%	45%	Low end trim required.
HomeWorks QS	HQRD-10ND	1	21	20%	90%	45%	Low end trim required.
Panel Module	HW/LP-RPM-4A-120	1	40	20%	98%	45%	Low end trim required. Set load type to FP. Rating is per channel; total per module is 64.

**Interfaces**