

Designer Bell Solar Lights

Search Code: SC65414



FEATURES

- *High Efficiency: Up to 160 lm/W.*
- *Durable Construction: Die-cast aluminum housing with a bronze powder coat Finish.*
- *Diameter Size Options: 16 Inch, 20 Inch, and 23 Inch.*
- *Lens: High Light Transmittance PC, anti-UV and Fire Resistant.*
- *LED: Lumileds 2835.*
- *Aluminum LED board: High Conductive, Waterproof, Aging Resistance, Salt eRistance.*
- *Customizable Settings: Multi Color Temperature. Selectable switch inside fixture. Available in 3000K/4000K/5000K.*
- *IP Rating: IP66, Suitable for Wet Locations.*
- *Beam Angle: Type V (150° X 150°).*
- *Long Lifespan: Rated for up to 50,000 operational hours.*

ELECTRICAL

- *Wattage: 50W.*
- *Lumens: 8000L Max.*
- *Input Voltage: 120-277V.*
- *CRI: >70.*
- *Power Factor: 0.9*
- *Efficacy: 160 LPW*
- *Operating Temperature Range: (-17°C to 40°C) 0°F to 104°F.*

APPLICATION

- *Gardens.*
- *Amusement Parks.*
- *Residential Quarters.*
- *Industrial Parks.*
- *Pedestrian Streets.*



WARRANTY & LISTINGS

- *Warranty: 5 years. 50,000 operational hours.*
- *Certifications: Energy Star Rated, ETL Listed, IP65 Wet Rated.*

BATTERY

- *Battery Charge Time To Full Level: 6 to 12 Hours. Depending on the sunlight quality.*
- *Battery Type: LiFePO4.*
- *Battery Life: More Than 2000 Cycles (2000/365days=5.47 Years) with overcharge and over-discharge protection.*
- *Operation On Full Charge: 10 hrs. Depending on the sunlight quality.*

LIGHT HEAD DIMENSIONS

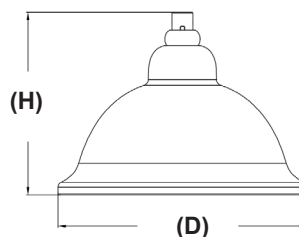

Model	Dimensions
DBSL-16	16½" (D) x 12" (H)
DBSL-20	19¾" (D) x 14" (H)
DBSL-23	23" (D) x 14" (H)

TENON DIMENSIONS

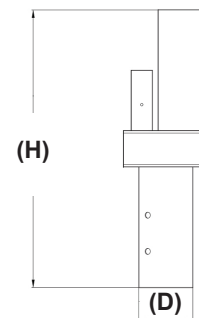

Tenon Adapter Size
3½" (D) x 18" (H)
4½" (D) x 18" (H)
5½" (D) x 18" (H)

ORDERING INFORMATION

Product Code	Size	Number Of Lights	Tenon Adapter Size
DBSL-16-1-MCT-3-K	16 Inch Diameter	Single	3 Inches
DBSL-16-1-MCT-4-K	16 Inch Diameter	Single	4 Inches
DBSL-16-1-MCT-5-K	16 Inch Diameter	Single	5 Inches
DBSL-16-2-MCT-3-K	16 Inch Diameter	Double	3 Inches
DBSL-16-2-MCT-4-K	16 Inch Diameter	Double	4 Inches
DBSL-16-2-MCT-5-K	16 Inch Diameter	Double	5 Inches

Designer Bell Solar Lights

Search Code: SC65414



ORDERING INFORMATION

Product Code	Size	Number Of Lights	Tenon Adapter Size
DBSL-20-1-MCT-3-K	20 Inch Diameter	Single	3 Inches
DBSL-20-1-MCT-4-K	20 Inch Diameter	Single	4 Inches
DBSL-20-1-MCT-5-K	20 Inch Diameter	Single	5 Inches
DBSL-20-2-MCT-3-K	20 Inch Diameter	Double	3 Inches
DBSL-20-2-MCT-4-K	20 Inch Diameter	Double	4 Inches
DBSL-20-2-MCT-5-K	20 Inch Diameter	Double	5 Inches
DBSL-23-1-MCT-3-K	23 Inch Diameter	Single	3 Inches
DBSL-23-1-MCT-4-K	23 Inch Diameter	Single	4 Inches
DBSL-23-1-MCT-5-K	23 Inch Diameter	Single	5 Inches
DBSL-23-2-MCT-3-K	23 Inch Diameter	Double	3 Inches
DBSL-23-2-MCT-4-K	23 Inch Diameter	Double	4 Inches
DBSL-23-2-MCT-5-K	23 Inch Diameter	Double	5 Inches

PHOTOMETRICS

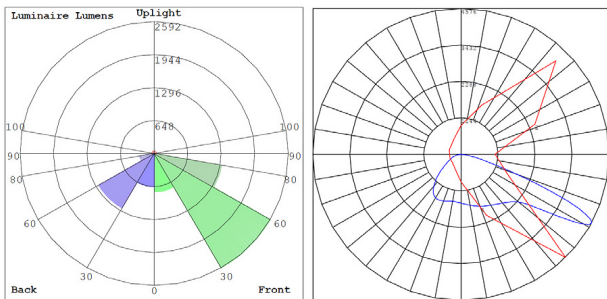

BUD Rating: B3-U0-G2

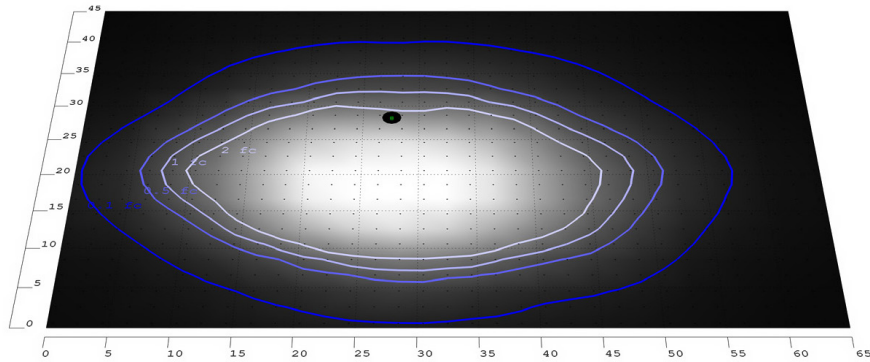

50W 5000K, Area 45'x 65' Mounting Height: 9'

DBSL SERIES EXAMPLE



DBSL-16 (Single)



DBSL-16 (Double)



DBSL-20 / DBSL-21 (Single)



DBSL-20 / DBSL-21 (Double)