

Landscape LED Flood Lights

Search Code: SC12431



FEATURES

- Die-cast aluminum optimize the best heat dissipation management as the main part of the fixture, which effectively improves the LED efficiency.
- Durable powder coating and fully sealed tempered glass lens.
- Suitable for applications requiring 1.5G vibration test according to ANSI C136.31.
- Power adjustable and color selectable: 3000K, 4000K, 5000K *on select models.
- Reliable IP65 structural design.
- Lifespan: Up to 50,000 hours.
- Integrated Photocell *on select models.

ELECTRICAL

- Universale 120-277VAC Input Volatge.
- 0-10V dimming driver.
- Four adjustable wattage levels available for each model: 100% 80% 60% 40%.
- Both drivers have a power factor >90%, THD 20%.
- Power Factor: >0.9.
- Operating Temperature Range: 0°F to 104°F (-17°C to 40°C)
- CRI: 70



WARRANTY & LISTINGS

- Warranty: 5 years (50,000 operational hours).
- Certifications: UL, cULus for wet locations, DLC Compliant.

MOUNTING

- Available in 1/2" knuckle, Slipfitter or Trunnion mounts.

PHOTOMETRICS

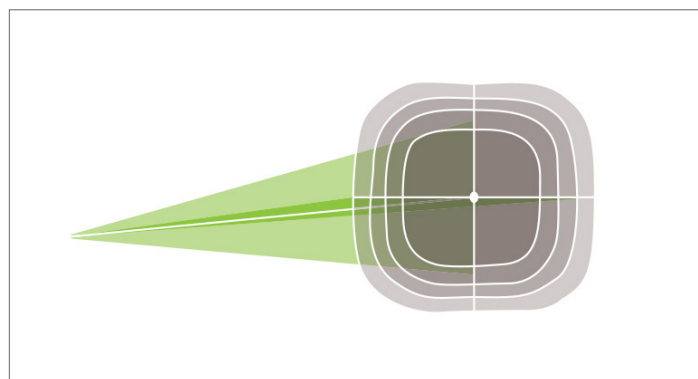

Optics(NEMA Type): 7Hx7V.

ORDERING INFORMATION

Product Code	Wattage	Replaces	Lumens	Color Temperature	Mounting
6603-27MCT-KN-P	Watt Select 27/20/15/11	100W MH	2800L	Color Select 3K/4K/5K	Knuckle Mount
6603-65MCT-TR-P	Watt Select 65/54/41/27	200W MH	9400L	Color Select 3K/4K/5K	Trunnion Mount
6603-65MCT-KN-P	Watt Select 65/54/41/27	200W MH	9400L	Color Select 3K/4K/5K	Knuckle Mount
6603-120MCT-TR-P	Watt Select 120/98/71/52	400W MH	18000L	Color Select 3K/4K/5K	Trunnion Mount
6603-120MCT-SF-P	Watt Select 120/98/71/52	400W MH	18000L	Color Select 3K/4K/5K	Slipfitter
FL4-150W-750-UD-Y-PC	150W	400W MH	19,500L	5000K Daylight	Trunnion Mount
FL4-150W-750-UD-SF-PC-K	150W	400W MH	19,500L	5000K Daylight	Slipfitter

Landscape LED Flood Lights

Search Code: SC12431

DIMENSIONS

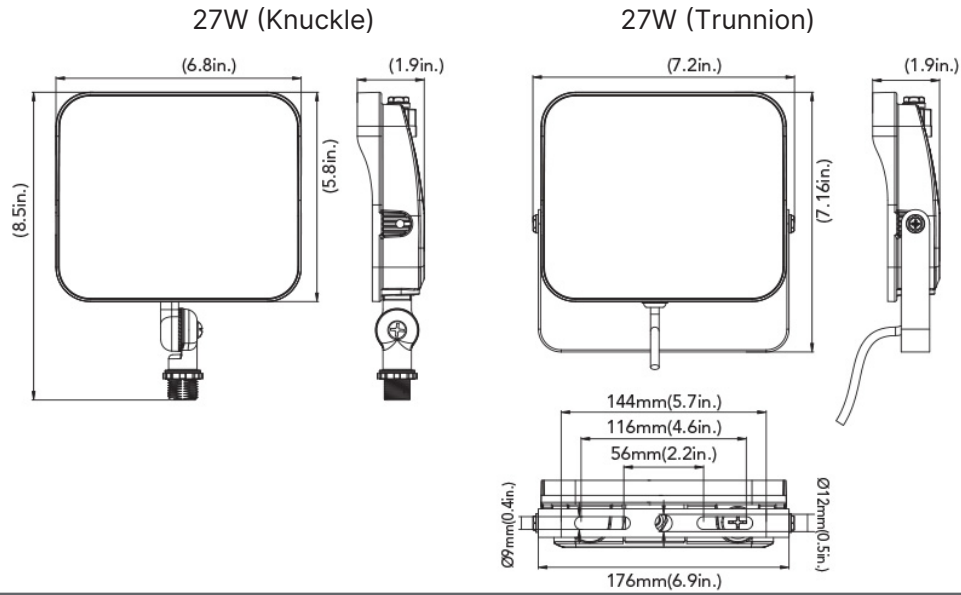

DIMENSIONS

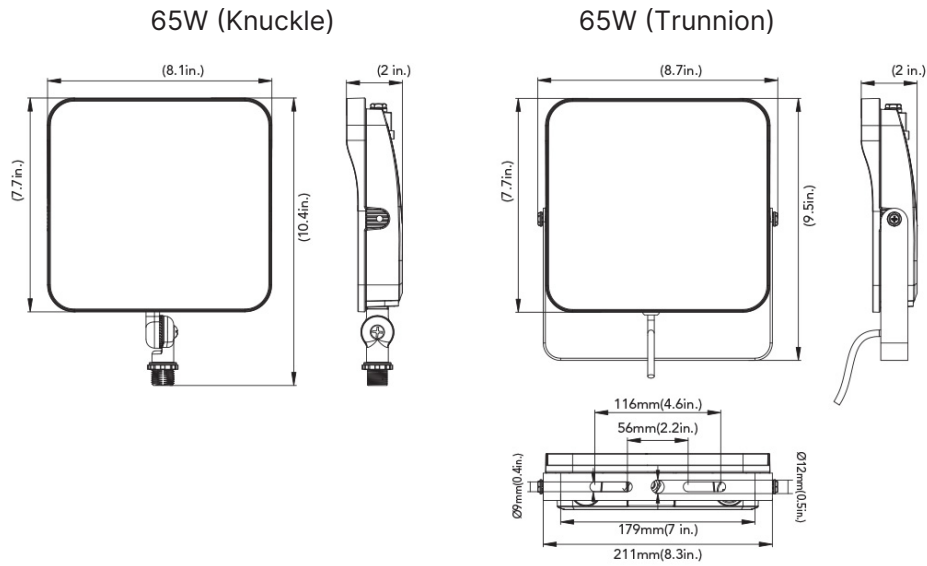

DIMENSIONS

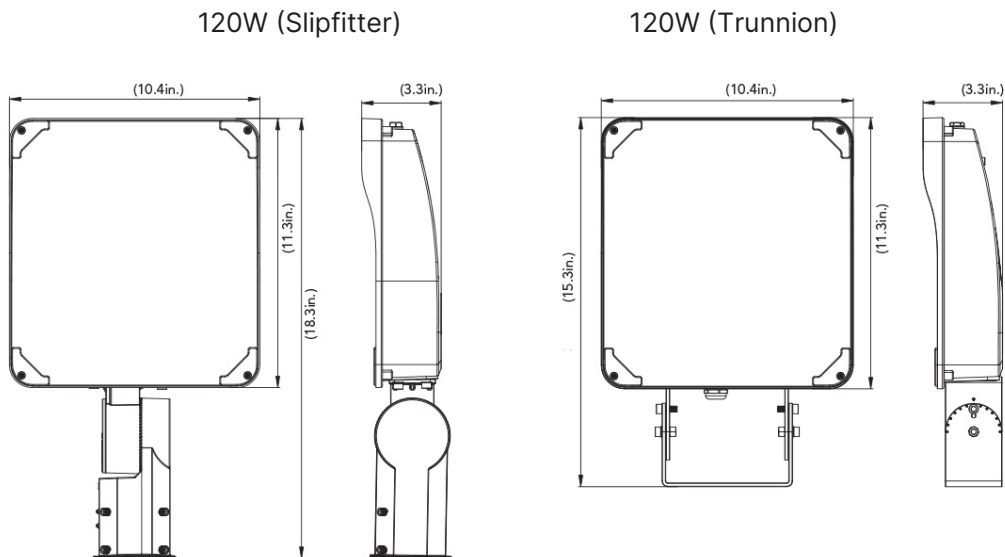

Landscape LED Flood Lights

Search Code: SC12431



DIMENSIONS

150W (Slipfitter)

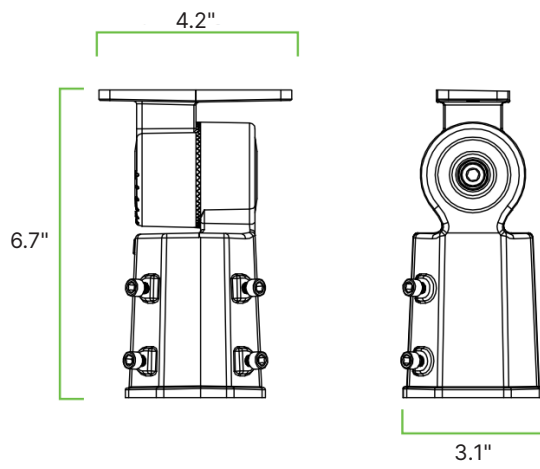

150W (Trunnion)

